



6/133 Burswood Road Burswood, WA



## Stylish Terrace Living

Opportunities to live in a stylish, secure complex on the doorstep of Perth's premier entertainment precinct are rare!

Let this apartment pleasantly surprise you with an enormous private terrace like you've never seen before. This 63m<sup>2</sup> north facing terrace is the perfect space for creating many a memory whilst enjoying morning coffees, evening vino's & summer BBQ's.

Both bedrooms include built in sliding door robes and access direct to the terrace.

Just a handball from Optus Stadium, Vic Park Cafe strip & the Crown Entertainment Complex, apartment living has never looked so good.

\* Split system air-conditioning in the living

**Council Rates:** \$312.63 p/q  
**Water Rates:** \$263.07 p/q  
**Strata Rates:** \$1,036.56 p/q

**Troy Houlahan**

0411 127 920

**Katie Houlahan**

0401 283 932

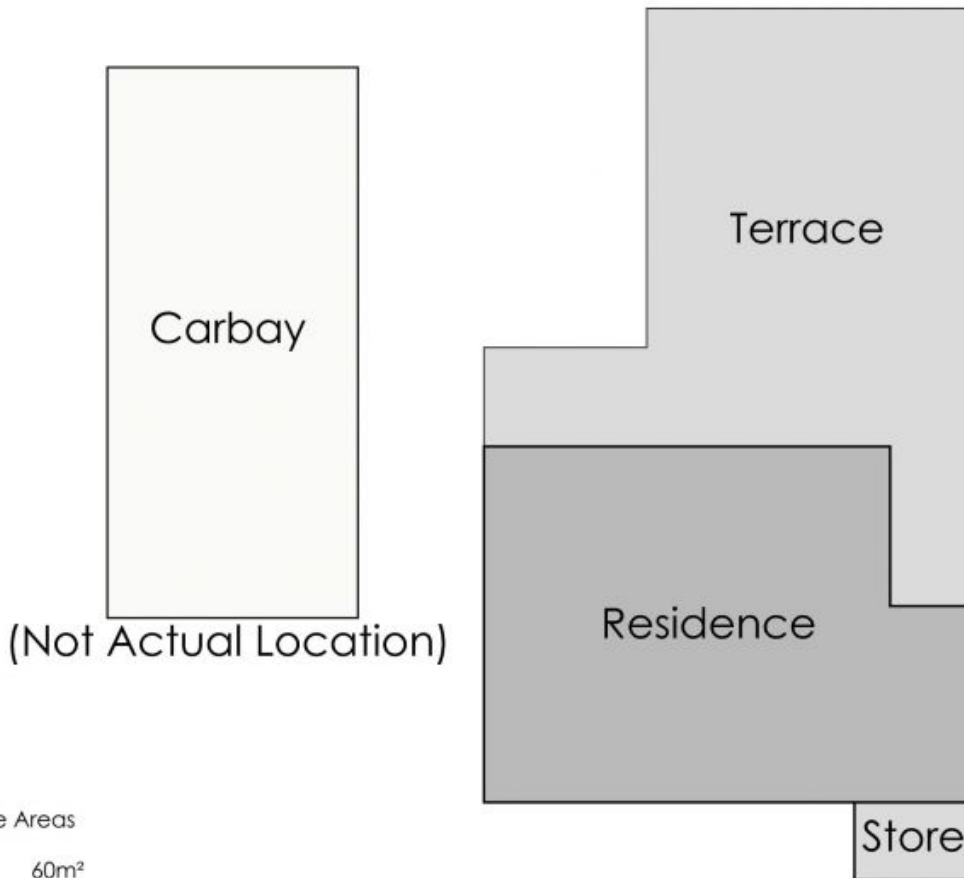
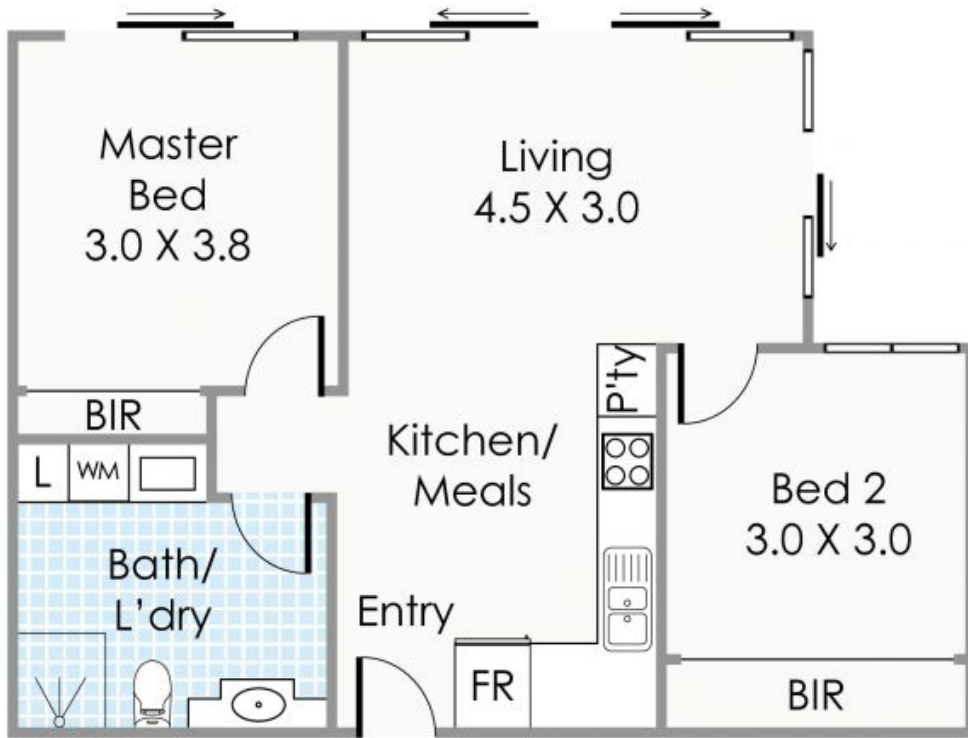

Approximate Areas

- Residence: 60m<sup>2</sup>
- Terrace: 63m<sup>2</sup>
- Carbay: 14m<sup>2</sup>
- Store: 4m<sup>2</sup>

This floorplan is for illustration purposes only to show the layout of the property. Measurements and total areas do not include or account for wall thickness or roof area under eaves. Not to be used for any other purpose.  
[www.creative.com.au](http://www.creative.com.au)